

FLAT WASHER, 1/2 USS, BLCK

2-2903 NYLOC NUT, 1/2-13,G8,BLK

1-0812 EYEBOLT, 1/2-13X3.25\"/>

1-0812 EYEBOLT, 1/2-13X3.25\"/>

FLAT WASHER, 1/2 USS, BLCK

1-0812 EYEBOLT, 1/2-13X3.25\"/>

FLAT WASHER, 1/2 USS, BLCK

FLAT WASHER, 1/2 USS, BLCK

2-2903 NYLOC NUT, 1/2-13,G8,BLK

1-0810 SUSPENSION
TUBE

2-2903 NYLOC NUT,
1/2-13,G8,BLK

FLAT WASHER,
1/2 USS, BLCK

FLAT WASHER, 1/2 USS, BLCK

2-2903 NYLOC NUT, 1/2-13,G8,BLK

1-0812 EYEBOLT, 1/2-13X3.25\"/>

FLAT WASHER,
1/2 USS, BLCK

39.00

2.00

6.65

50.63

Notes:
Unless Otherwise Specified

1. MATERIAL:
1. 1-0810 SUSPENSION TUBE, 57\"/>
 - 2. EYEBOLT, 1/2-13 X 3.25\"/>
 - 3. FLAT WASHER, 1/2 USS, BLACK ZNC (8 PCS)
 - 4. NYLOC NUT, 1/2-13, GRADE 8, BLACK ZINC
2. PACKAGING:
1. 1-0026 PRODUCT LABEL, .75 X 4\"/>
 - 2. PACKAGE LABEL, 2X11 PL12-SB
 - 3. POLYTUBE, 4\"/>
 - 4. POLY BAG, 4X7X4MIL
 - 5. CARTON, 62.5X7.5X2.5 RETT OR 5 PNL

UNLESS OTHERWISE SPECIFIED:			
DIMENSIONS ARE IN INCHES			
TOLERANCES:		TITLE:	
FRACTIONAL ± 1/64		HS-12 Rigging Hanging Set	
ANGULAR: MACH ± 5°		NEXT ASSY:	
TWO PLACE DECIMAL ± .03		USED ON:	
THREE PLACE DECIMAL ± .01		SIZE DWG. NO. REV	
INTERPRET GEOMETRIC TOLERANCING PER:		B 1-HS-12 00	
MATERIAL:		SCALE: 1:8 WEIGHT: 27.81LBS SHEET 1 OF 1	
FINISH:			
DO NOT SCALE DRAWING			

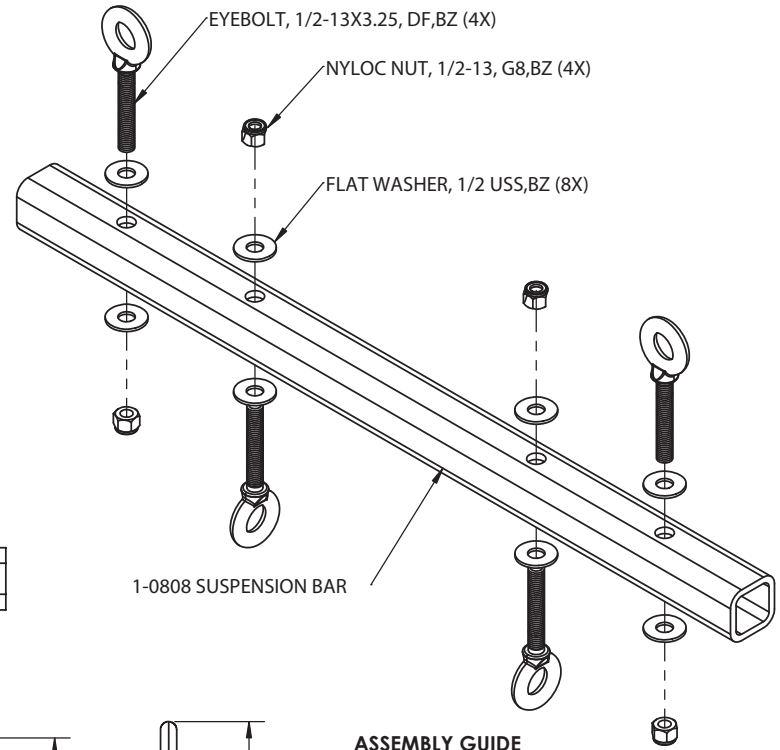
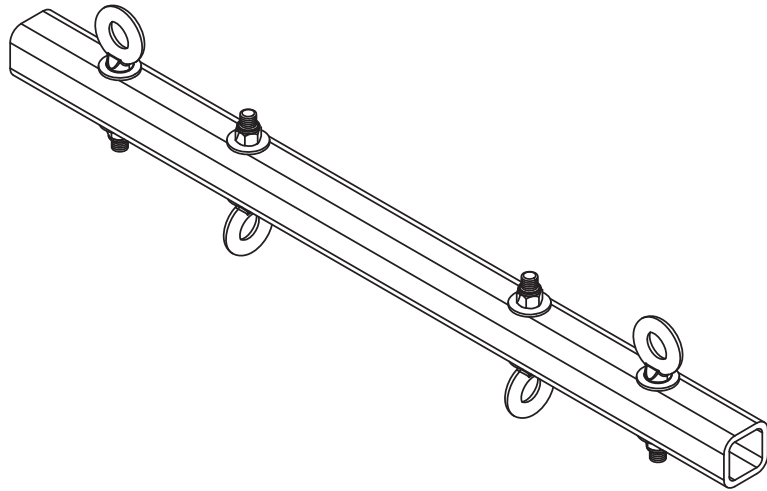

ASSEMBLY GUIDE

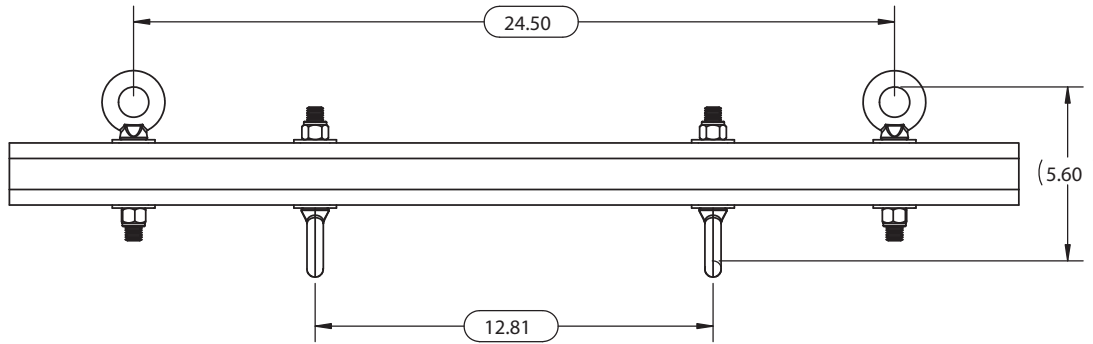
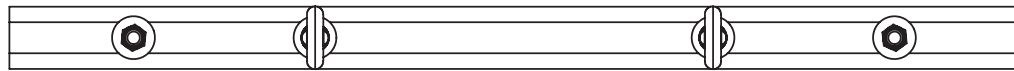

UNLESS OTHERWISE SPECIFIED:			
DIMENSIONS ARE IN INCHES			
TOLERANCES:			
FRACTIONAL: ± 1/64			
ANGULAR: MACH ± .5°			
TWO PLACE DECIMAL ±.03			
THREE PLACE DECIMAL ±.01			
INTERPRET GEOMETRIC TOLERANCING PER:		TITLE: HS-11 Rigging Hanging Set	
MATERIAL		NEXT ASSY:	
FINISH		USED ON:	
DO NOT SCALE DRAWING		SIZE B	
		DWG. NO. 1-HS-11	
		REV 00	
		SCALE: 1:4	
		WEIGHT:	
		SHEET 1 OF 1	